



# 1 1/4" BORE ACCESSORIES



## MOUNTING NUTS

### Stud Nut

Part Number	Across Flats	Nut Thickness	Nut (Thread)
N12-16	1 3/32"	27/64"	3/4-16

### Rod Nut

Part Number	Across Flats	Nut Thickness	Nut (Thread)
N06-24A	9/16"	7/32"	3/8-24
N06-24B	1/2"	1/8"	3/8-24

## CB-2095

Clevis Bracket  
Material: steel, bright zinc plated

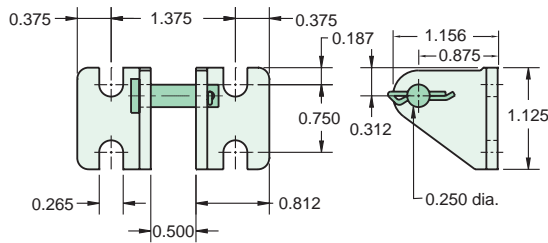

## RC-2081

Rod Clevis  
Material: steel, bright zinc plated

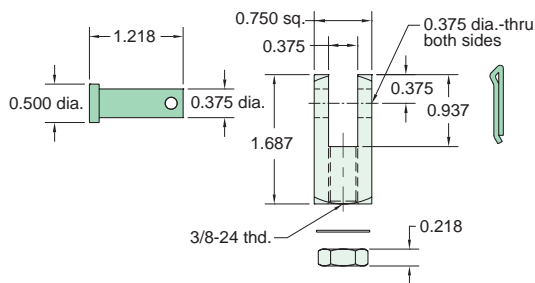

## RE-2085

Rod End  
Material: steel, bright zinc plated body

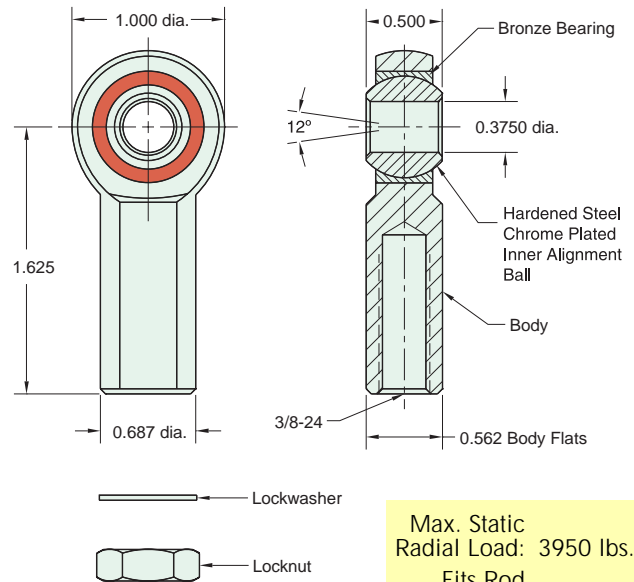

Max. Static Radial Load: 3950 lbs.  
Fits Rod Thread Size: 3/8-24

## FB-2491

Foot Bracket  
Material: steel, bright zinc plated

